

## Specification for 1575.42MHz GPS L1 Ceramic Filter

### MtronPTI P/N: CF9733

#### 1. Electrical Specifications:

Parameter	Unit	Specification
Center Frequency	MHz	1575.42
Bandwidth	MHz	FC±10.25 (1565.17 ~ 1585.67Mhz)
Insertion Loss in B.W	dB	3.0 (Max)
Ripple in BW	dB	1.0 (Max)
V.S.W.R in B.W	-	2.0 : 1
Attenuation	dB	40.0 (Min) @ FC+/-50Mhz
		65.0 (Min) @ FC+/-100Mhz
Input Power	Watt	1.0 (Max)
IN/OUT Impedance	Ω	50
Operating Temp. Range	°C	-40 ~ +85

#### 2. Dimensions:

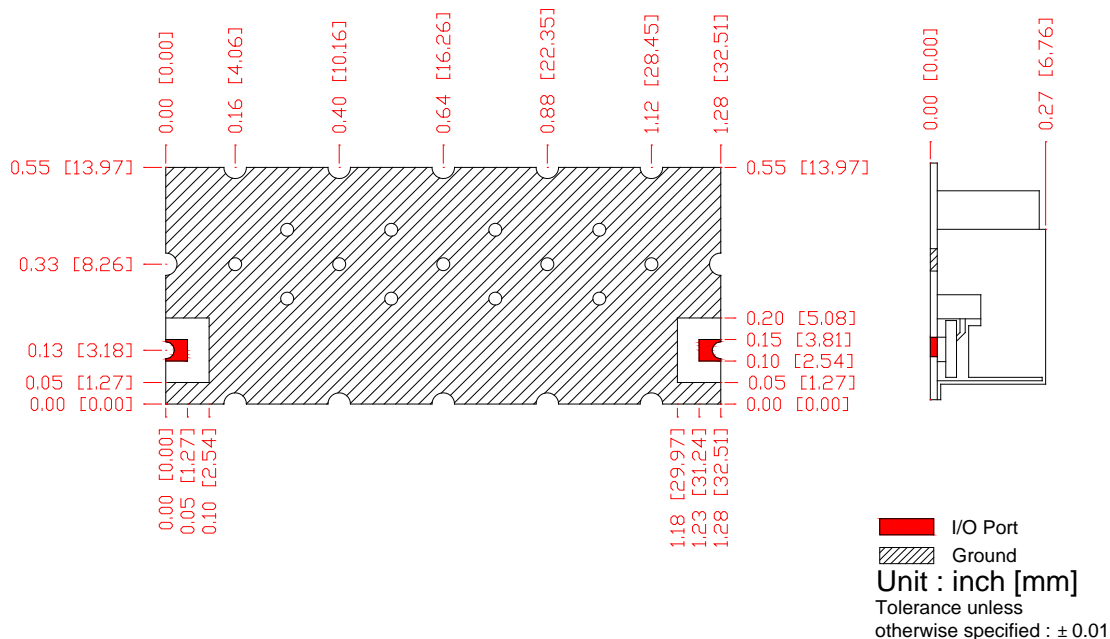

#### Datasheet Revision Table:

Date	Rev.	Author.	Details of Revision
01-12-17	0	DPD	Preliminary Specification